

BONO XTRA

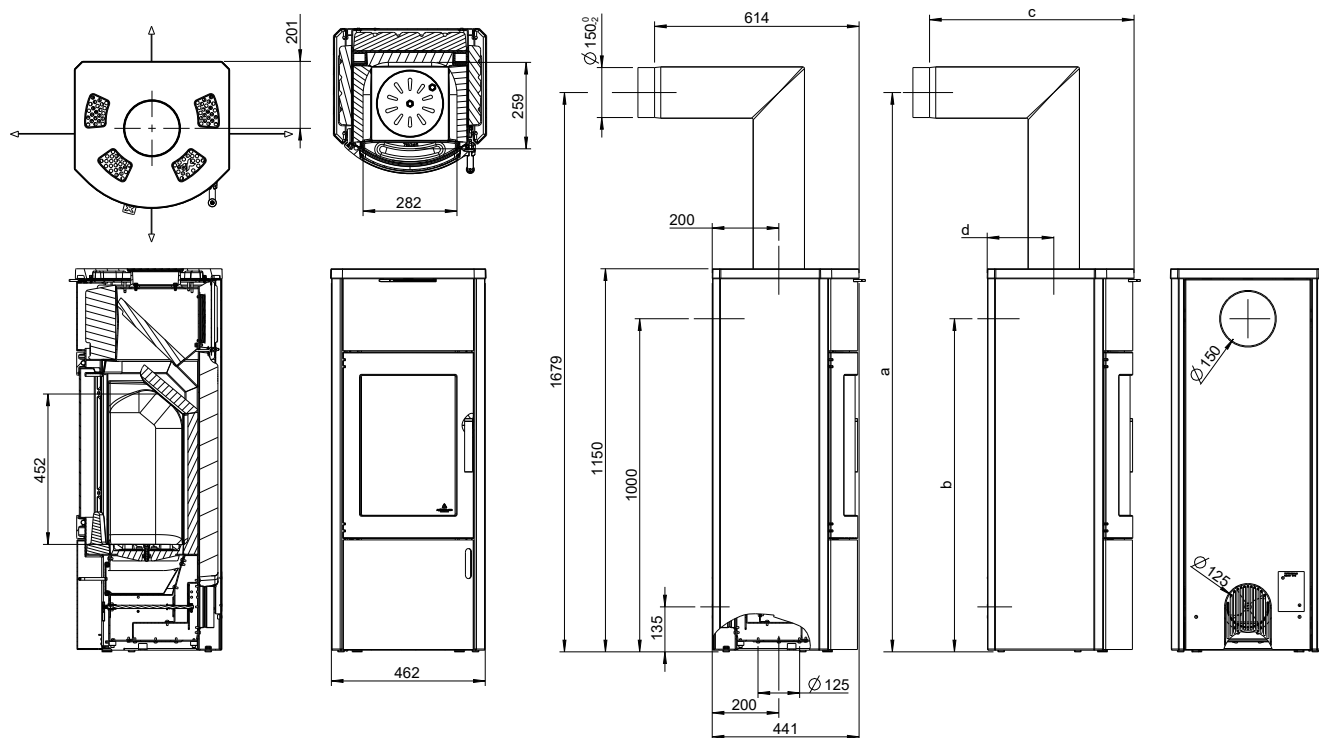

AUSTROFLAMM



Dimensions and weight	
Height [mm]	1150
Width [mm]	462
Depth [mm]	441
Combustion chamber width [mm]	282
Combustion chamber height [mm]	452
Combustion chamber depth [mm]	259
Baking compartment width [mm]	-
Baking compartment height [mm]	-
Baking compartment depth [mm]	-
Warming drawer, width [mm]	-
Warming compartment height [mm]	-
Warming drawer, depth [mm]	-
Dimensions, a (with Austroflamm elbow piece) [mm]	1679
Dimensions, b (with Austroflamm elbow piece) [mm]	1000
Dimensions, c (with Austroflamm elbow piece) [mm]	614
Dimensions, d (with Austroflamm elbow piece) [mm]	200
Flue pipe outlet, diameter [mm]	150
Outside air connection diameter [Ø mm]	125
Weight, basic appliance [kg]	219
Weight Xtra [kg]	107
Weight, HMS [kg]	-
Total weight inc. steel case (STM) [kg]	237
Total weight inc. ceramic case (KGM) [kg]	-
Total weight inc. soapstone case (SPM) [kg]	310
dP Radiation front [mm]	900
dS1 Distance left [mm]	270
dR Distance rear [mm]	160
dS2 Distance right [mm]	270
dB Distance bottom [mm]	0
Minimum distance from non-flammable materials [mm]	50
Output	
Nominal heat efficiency [kW]	5.0
Minimum heat output [kW]	2.5
Maximum heat output [kW]	7.0
Minimum room heating capacity [m³]	48
Maximum room heating capacity [m³]	124
Energy efficiency class	A
Data for the chimney sweep	
Exhaust gas mass flow [g/s]	4.2
Flue gas temperature [°C]	322
Minimum delivery pressure at nominal heat output [Pa]	12
at 0.8 times nominal heat output [Pa]	10
Equipment	
Xtra heat storage technology	Standard
Heat Memory System	-
External air connection / operation independent of ambient air	Yes
Ash removal	Ash pan

- not available